

SIDE-POWER

Thruster systems

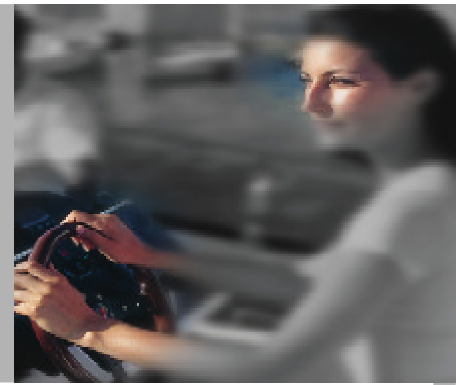

SP 285 TC



MAIN FEATURES

Thrust at 21 V	285 kg / 627 lbs.
Power	15 kW / 20 Hp
Tunnel diameter	300 mm / 11,8"
Propulsion system	Counter rotating
Voltage	48 V (24 V kit incl.)
Weight	73 kg / 160 lbs.
Boat size	74 - 100 foot
Current draw	nom. 430 A (48 V)
Min. battery CCA DIN	2 x 450-24 V

We invented the 24-48 V concept.

This is the most powerful DC electric thruster on the market. A very effective alternative to hydraulic thrusters that historically have been used for this performance.

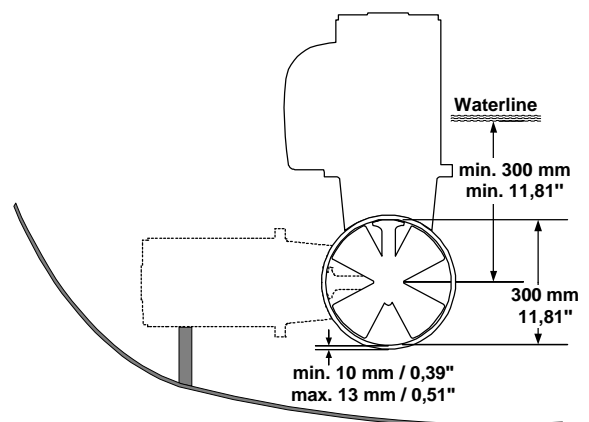
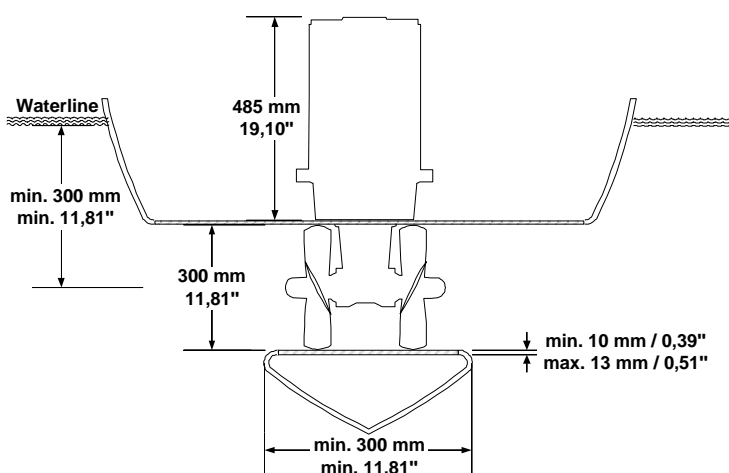

Sleipner Motor AS

P.O. Box 519
N-1612 Fredrikstad
Norway

Tel: +47 69 30 00 60
Fax: +47 69 30 00 70

www.side-power.com
sidepower@sleipner.no

